

## Compact Size Stepper Motor

### SM6-20 / LA6-20

Permanent Magnet Type

#### ■ Feature

- Compact Size
- High Speed, High Torque
- Low Electricity Consumption

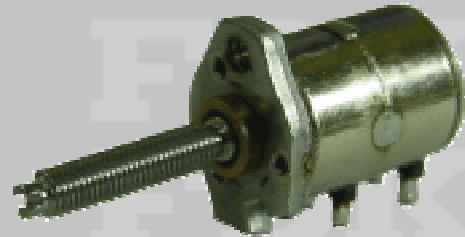

#### ■ Application

- Digital still camera

#### ■ Specification

Drive Mode	Bipolar
Exacting Method	2 Pahse
Number of Steps	20
Driving Voltage	3.0V
Coil Resistance / Phase	50
Pull-in Torque	0.15 mN · m (@600PP)

The descriptions in this catalogue are subject to change without notice.